



DHM9 INKREMENTÁLIS ÉRZÉKELŐ

DHM9-INKREMENTTIANTURI

- Felbontás max. 80 000 P / K
- IP 66 és IP67
- Kábel, csatlakozó vagy csatlakozó doboz
- Opcionális hajtómű



TERMÉKLEÍRÁS

MŰSZAKI ADATOK

Befoglalási átmérő	90 mm
Csatlakozás	Kábel, M23 érintkező
Érzékelő típusa	Differenciális
IP-osztály	IP66, IP67
Kilépés	Push/Pull
Max. impulzusszám	80000
Max. sebesség	9000 rpm
Max. tápfeszültség, DC	30 V DC
Max. tengelyátmérő	12 mm
Max. üzemi hőmérséklet	100 °C
Min. tápfeszültség, DC	5 V DC
Min. tengelyátmérő	11 mm
Min. üzemi hőmérséklet	-40 °C

ORDERING REFERENCE Contact the factory for special versions (over speed, electronics 5.30V, special fringes, connections...)

DIMAP	Shaft Ø	Electronics 24V, PG5, W22, SGT		Output signals	resolution	Connections	Orientation connection
		Supply	Output signals				
DIMAP 1 Stainless steel body	11.1mm	2 5Vdc	G2 cable 5Vdc RS422	A, A', B, B', C/D (A/B gated)	96 000 max	G6/G3 24Vdc CW G6/G3 24Vdc CCW G8 connection box G1 sensor cable 4-pins	A: axial B: radial
	12.12mm	2 5Vdc	G2 cable 5Vdc RS422	A, A', B, B', C/D (A/B gated)	96 000 max	G6/G3 24Vdc CW G6/G3 24Vdc CCW G8 connection box G1 sensor cable 4-pins	A: axial B: radial
DIMAP 2 Stainless steel cover and body	11.1mm	1 11 to 30Vdc C1 11mm 20mm	G5 push-out 5-30Vdc transistorised	A, A', B, B', C/D (A/B gated)	96 000 max	G3 PVC cable 8-wire G4 PFC cable 12-wire	Example: R800 radial cable 2m A100 axial cable 10m
	12mm	1 4.75 to 30Vdc C2 12mm 25mm	G5 push-out 11-30Vdc transistorised	A, A', B, B', C/D (A/B gated)	96 000 max	G3 PVC cable 8-wire G4 PFC cable 12-wire	Example: R800 radial cable 2m A100 axial cable 10m
Ex. DIMAP	- 11 //	5	W1 sine 5Vdc	G5	9 // 96 000 //	GP	R000

Available resolutions (10°C electronic) : 5 10 20 25 30 60 100 120 125 127 150 180 200 240 250 256 300 314 360 375 400 500 512 600 720 750 768 800 900 960 1000 1024 1200 1250 1280 1440 1500 1800 2000 2048 2400 2500 3000 3600 4000 4096 5000 6000 7200 8000 8192 8000

Interpolated available resolution (PFC electronic) : 1000 2500 2880 3072 4320 5120 7500 9000 10240 10800 12000 12500 12700 14400 15000 16200 16800 20000 20480 24000 28800 30000 32000 32768 36000 40000 40960 43200 48000 49152 50000 57600 60000 64000 65536 80000 80000

Available resolutions sine-wave signals (10°C electronic) : 250 256 300 500 1024 2000 3000

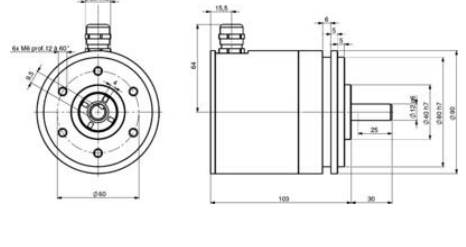
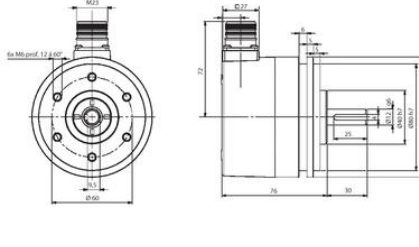
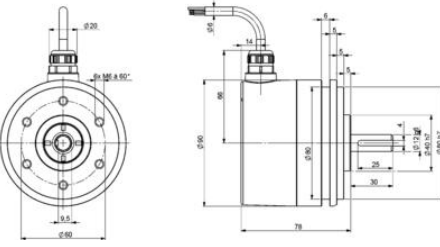
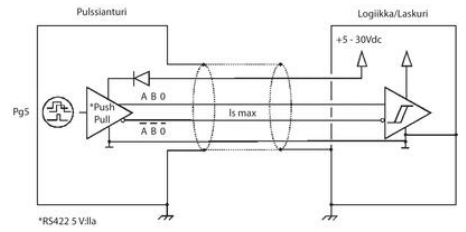
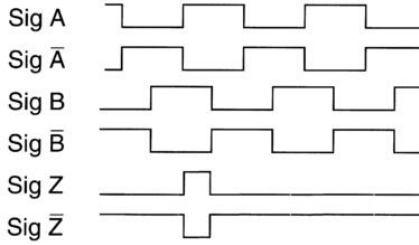

ORDERING REFERENCE Contact the factory for special versions (over speed, electronics 5.30V, special fringes, connections...)

DIMAP	Shaft Ø	Electronics 24V, PG5, W22, SGT		Output signals	resolution	Connections	Orientation connection
		Supply	Output signals				
DIMAP 1 Stainless steel body	11.1mm	2 5Vdc	G2 cable 5Vdc RS422	A, A', B, B', C/D (A/B gated)	96 000 max	G6/G3 24Vdc CW G6/G3 24Vdc CCW G8 connection box G1 sensor cable 4-pins	A: axial B: radial
	12.12mm	2 5Vdc	G2 cable 5Vdc RS422	A, A', B, B', C/D (A/B gated)	96 000 max	G6/G3 24Vdc CW G6/G3 24Vdc CCW G8 connection box G1 sensor cable 4-pins	A: axial B: radial
DIMAP 2 Stainless steel cover and body	11.1mm	1 11 to 30Vdc C1 11mm 20mm	G5 push-out 5-30Vdc transistorised	A, A', B, B', C/D (A/B gated)	96 000 max	G3 PVC cable 8-wire G4 PFC cable 12-wire	Example: R800 radial cable 2m A100 axial cable 10m
	12mm	1 4.75 to 30Vdc C2 12mm 25mm	G5 push-out 11-30Vdc transistorised	A, A', B, B', C/D (A/B gated)	96 000 max	G3 PVC cable 8-wire G4 PFC cable 12-wire	Example: R800 radial cable 2m A100 axial cable 10m
Ex. DIMAP	- 11 //	5	W1 sine 5Vdc	G5	9 // 96 000 //	GP	R000

Available resolutions (10°C electronic) : 5 10 20 25 30 60 100 120 125 127 150 180 200 240 250 256 300 314 360 375 400 500 512 600 720 750 768 800 900 960 1000 1024 1200 1250 1280 1440 1500 1800 2000 2048 2400 2500 3000 3600 4000 4096 5000 6000 7200 8000 8192 8000

Interpolated available resolution (PFC electronic) : 1000 2500 2880 3072 4320 5120 7500 9000 10240 10800 12000 12500 12700 14400 15000 16200 16800 20000 20480 24000 28800 30000 32000 32768 36000 40000 40960 43200 48000 49152 50000 57600 60000 64000 65536 80000 80000

Available resolutions sine-wave signals (10°C electronic) : 250 256 300 500 1024 2000 3000

